

## Installation Instructions

### Wallflex

Materials shall be installed in accordance with current AUSTRALIAN STANDARDS 1884 Floor coverings – Resilient sheet and tiles – Installation practices and these instructions.

**Please read all instructions before you begin the installation.**

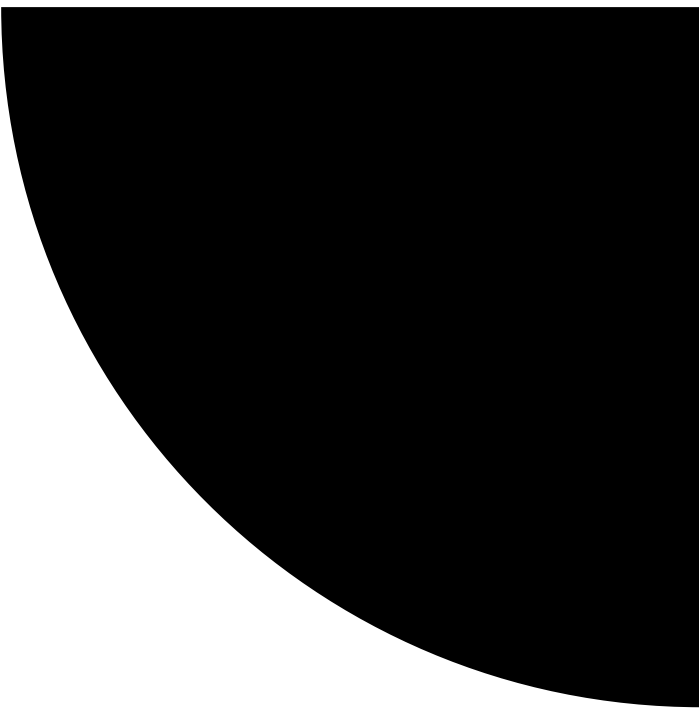

# Installation Instructions

## WALLFLEX

Please read all instructions before you begin the installation.

### QUICK REFERENCE GUIDE

#### Installation:

Conform to current AS 1884 standard

#### Type of wall surface suitable:

Properly prepared:

- Smooth cement render
- Fibre cement sheet
- Plaster board
- Hardboard sheet
- Plywood
- Steel or aluminium sheeting

#### Installation system:

Full spread, heat-welded seams

#### Adhesives:

SV-200 / LVT-100

SC-100 – Contact Adhesive

Nexus 180 water based contact

#### Trowel Size:

SV-200 / LVT-100

- Armstrong Flooring S891— 0.8mm x 0.8mm x 2.0mm notches. (fine notched steel trowel)
- V1— 1.6mm x 1.6mm x 1.6mm
- U1 trowel 0.80mm x 0.80mm notches
- SC100 Contact adhesive (brush or roller)
- Nexus 180 water based contact, (roller)

#### Recommendations:

Maintain room at and allow material to acclimatise at minimum 15°C for 24 hours before & 48 hours after installation.

Minimum corner radius:

- 2.00mm Wallflex @ 8.00mm
- 1.25mm Wallflex @ 5.00mm

Warm material to bend around corners using hot air gun.

After application, apply pressure with a hand roller to set adhesive & expel air bubbles.

Use CONTACT ADHESIVE on non-porous surfaces.

Installation is ideally suited to two installers.

#### Weld Rod:

Use matching Armstrong Flooring PVC weld rod

### TO THE INSTALLER

Please note that if material has been cut, fitted or installed, NO ADJUSTMENTS or CLAIMS (if any) will be considered due to the failure to comply with any of the following. Before cutting and installing Armstrong Flooring wall coverings make sure that you:

1. Check for obvious transit damage or manufacturing defects in good daylight conditions.
2. Check that the material is the correct colour, pattern and quantity ordered by the customer
3. Material should be allowed to relax in a flat form to allow it to acclimatise to job climatic conditions. Roll out flat and stack up to ten sheets for 24 hours at 18°C. Never install the material if the temperature in the room is less than 15°C as per current AS 1884 Section 4.1.1.
4. Use only Armstrong Flooring recommended adhesive specifically formulated for each Armstrong product.
5. All rolls of Armstrong Flooring products are marked with a 'batch number', and roll number. When using more than one roll make sure the rolls have the same 'batch number' and in-stalled in roll number order.
6. After cutting material off the roll, step back and inspect the overall effect. If acceptable, then go ahead and adhere, but if there seems to be a problem or doubt of any kind then stop immediately and call the distributor or Armstrong Flooring Customer Service on 1800 632 624.
7. Do not cut or install any damaged or defective material unless accepted, agreed and approved by all parties concerned.

### JOB SITE CONDITIONS

Temperatures in areas where Wallflex will be applied should be maintained at a minimum of 18°C for 24 hours prior, during and 48 hours after installation. Please note that cold walls have considerable influence on the open time of the adhesive used to install Wallflex..

### WALL SURFACE PREPARATION

#### Solid Construction Walls

Smooth cement rendered walls and hard wall plastered surfaces come under this category. Walls must be dry, clean and smooth and finished off with a steel trowel.

Whilst walls are not subject to hydrostatic pressure, they can be damp, thus, before commencing the installation ensure the walls are completely dry. This may take some time as the internal brickwork has to dry out as well.

Cement rendered walls finished with a steel trowel should be smooth enough for Wallflex installation. If cracks and holes exist, they should be levelled with a trowel-on underlayment.

#### Framed Construction

The following materials fall into this category:

- Plaster Board
- Fibre Cement Sheet
- Hardboard Sheet
- Plywood
- Steel or Aluminium Sheetting

All framed walls must be well supported and stable.

Nail heads, staples or other fasteners must be flush to the surface of the wall finish. Gaps, holes and uneven thickness of boards must be filled and levelled with patching compound (as per manufacturers recommendations).

Painted walls should be sanded and any loose paint scraped off.

**WALL TO FLOOR TRANSITION**

When installing 2.0mm Wallflex to join covered 2.0mm vinyl floorcoverings, heat weld the walling and flooring together to provide a smooth hygienically welded joint.

**Wall vinyl to Floor vinyl: 2.0mm vinyl to 2.0mm**

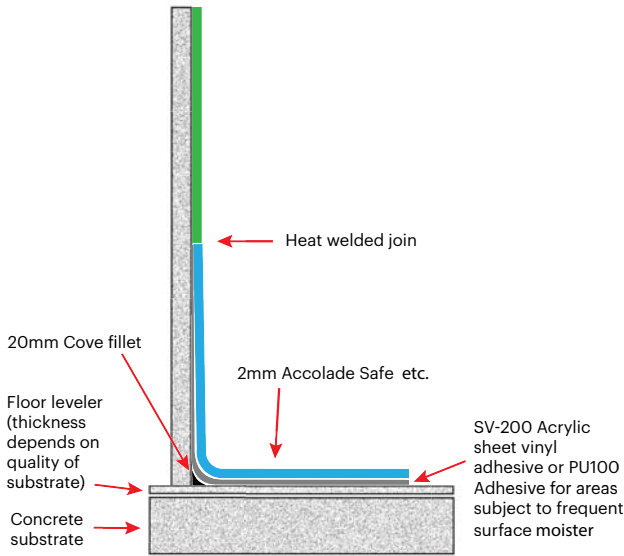

**Alternate – Wall vinyl to floor vinyl: Overlap**

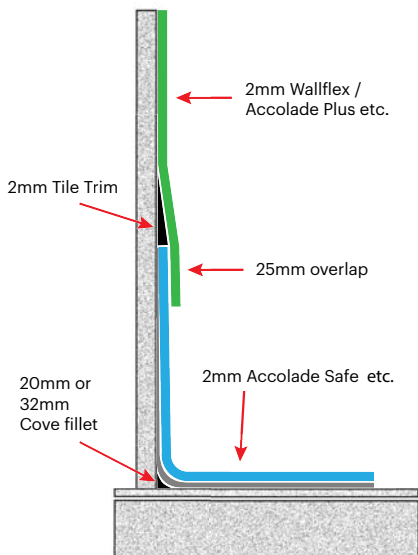

**INSTALLATION TECHNIQUES**

Ensure material is acclimatised, warm sheets at corners using hot air gun to bend around corners

**NOTE:** Minimum corner radius:

- 1.25mm Wallflex @ 5.00mm
- 2.00mm Wallflex @ 8.00mm

1. If installing Wallflex to a height of less than 1.50 metres, lengths should be laid horizontally.

2. Mark out a horizontal reference line along the wall at a height slightly lower than the width of the Wallflex from the floor or from the end of the coved flooring. This is to allow for trimming any unevenness of sub-floor.

**NOTE:** Allowances must be made to the horizontal reference line to cover the rake of the corners.

3. Do not install vertical seams in the wall corner – these are never straight and very difficult to weld. They are best placed 200 mm from the corner, obviously on the less visible angle.
4. Add 50mm to required length and cut Wallflex. This will allow for overlap at both ends. Remove factory edge if damaged or contaminated.
5. Mark the centre of the length and the corresponding centre of the wall.
6. When placing the Wallflex in position, make sure the factory edge matches the horizontal reference line of the wall and the corresponding centre marks. Then work toward each end.
7. **NOTE:** Armstrong Flooring Wall Capping Strip should be applied to cover any differences due to the rake of the corners.
8. The same method is used if Wallflex is installed vertically, but use a plumb line to give the first vertical starting line.
9. A band of approximately 100mm to 150mm of Contact Adhesive is applied below the horizontal line. Apply SV-200 to the remaining area. The band of Contact Adhesive is to prevent the sheets from slip-ping down because of the weight of the Wallflex.
10. If Wallflex is applied up to the ceiling height then the band of Contact Adhesive should be applied at the top.
11. Contact Adhesive is recommended at external corners. SV-200 is recommended at internal corners.
12. When applying Wallflex on the ceiling the Contact Adhesive is applied to the entire surface of the ceiling.

**ADHESIVE**

To ensure that the installation is successful, Armstrong Flooring SV-200 and/or SC 100 Contact Adhesive must be used. SV-200 is spread with a fine notched steel trowel, with 0.80mm x 0.80mm notches. The SV-200 adhesive must be allowed to 'tack-off' prior to the material being rolled back into it. Depending upon climatic conditions this may vary from 10 to 20 minutes.

Contact Adhesive is specially formulated contact adhesive that has a high plasticiser migration resistance. Contact Adhesive should be applied to both corresponding surfaces, wall and back of material.

For non-porous surfaces apply a thin coat of Contact Adhesive by brush or paint roller to both the wall and the back of the material (porous wall surfaces will require two coats). Adhesive must be allowed to 'touch dry' before joining coated surfaces together.

When placed in position, apply pressure with a hand roller.

**SEAMS**

One of the many advantages of Wallflex is the fact that it can be seam-welded to give a jointless, dust-free, watertight wall treatment. Grooving and welding should not be carried out until adhesive has completely set (usually 24 hours after sheet installation as moisture from adhesive can interfere with the heat welding process).

## Installation & Heat Welding

- All factory edges should be removed, using the Armstrong S-33 edge trimmer during installation.
- Scribe seams using Armstrong Flooring S-83 recess scribe set to provide a gap of 0.5mm. Cut on scribe line and roll cut edge into adhesive using hand roller.
- Heat welding should only be done when adhesive is completely cured (24 hours).
- Rout or groove the seam in a 'V' or 'U' shape to a minimum of 2/3rd of the material depth using a Master Turbo groover or Similar, or a hand groover with a sharp blade against a straight edge, so that both sides of the seam are grooved equally and uniformly.

## Welding

- Set temperature setting on the hot air welder, fitted with an speed nozzle, to deliver enough heat to fuse weld rod to Wallflex sheet. Amperage of electrical supply, length of extension cord and wire size will affect the temperature setting. As a guide, a Leister weld gun fitted with an speed nozzle should be set to heat setting of around 400 degrees. Test on a piece of scrap material until correct setting is achieved.

- Insert weld rod into the speed nozzle and immediately insert the rod into the groove.
- Hold the gun at an angle so that the tip of the speed nozzle is parallel with the material. A good weld will result when the rod just starts to flair, and no more, on each side of the seam. If the rod flairs excessively you are going too slow. Scorching of the material if the heat setting is too hot.
- To change directions in welding, shave off excess welding rod and groove the end of the rod for approximately 20mm. Start welding from the opposite direction and continue welding until you overlap the initial grooved weld rod and continue for another 20mm before lifting weld off.
- Allow weld rod to completely cool before skiving (trimming).
- Once weld rod is cooled off, skive off in two passes. The first pass using a Mozart or a quarter moon (spatula) knife with a trim plate. The second pass should be flush with the material. Too much weld rod flair or an uneven seam will result in the top surface of the material being removed exposing the material backing.

## ARMSTRONG FLOORING PTY LTD

FLOORCOVERINGS, ADHESIVES & ACCESSORIES MANUFACTURED IN AUSTRALIA AFTER 1st JANUARY, 1984  
DO NOT CONTAIN ASBESTOS

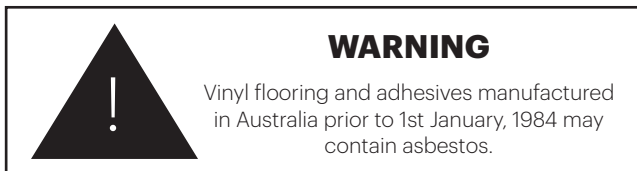

### Existing Resilient Flooring

Do not sand, dry sweep, dry scrape, drill, saw, beadblast, or mechanically chip or pulverise existing resilient flooring, backing, lining felt or asphaltic 'cut-back' adhesives.

These products may contain either **asbestos fibres** or **crystalline silica**.

Avoid creating dust. Inhalation of such dust is a cancer and respiratory tract hazard.

Unless positively certain that the product to be removed is a non-asbestos containing material, you must presume it contains asbestos. Regulations may require that the material be tested to determine asbestos content.

**Where do I go to find out more about asbestos?**

**Asbestos Awareness** [www.asbestosawareness.com.au](http://www.asbestosawareness.com.au) – provides information on a state by state basis about the dangers of asbestos, asbestos removal, who to contact and other important information.

**NOTE:** Vinyl flooring manufactured in Australia after January 1, 1984, **DOES NOT** contain asbestos. However, regulations, codes and directives as to the best method of handling asbestos do exist and it is the obligation of the installer to ensure that practices used are safe, without risk to health, and meet all legal requirements.

### Disclaimer—Asbestos issues

The warnings and guidance contained in these instructions in relation to the potential for asbestos in floorcovering materials are given in good faith. However, regulations, codes and directives as to the best method of handling asbestos are under continual revision. It is the obligation of the installer to ensure that practices used are safe, without risk to health, and meet all legal requirements.

Armstrong Flooring Pty Ltd accepts no liability for any loss, costs, expense or injury, however incurred, arising from the presence of any asbestos in any floorcovering materials or asphaltic 'cut-back' adhesives and/or any reliance placed upon the procedures and recommended practices contained in these instructions.

### Armstrong Flooring Pty Ltd

29 – 39 Mills Road, Braeside, 3195 Victoria Australia

For further information and samples:  
Australia Freecall 1800 632 624

Email [customer\\_services@armstrongflooring.com](mailto:customer_services@armstrongflooring.com) or contact us on the web

[www.armstrongflooring.com.au](http://www.armstrongflooring.com.au)

August 2021