

ARMSTRONG FLOORING – LAMINATE

Architectural Remnants™

Coastal Living™ Patina

Rustics™ Premium

New England Long Plank

Forest Select XL

Timberland Classics

Warranty Against Defects

Installation Instructions

Maintenance Instructions

WARRANTY AGAINST DEFECTS

Armstrong Flooring – Laminate

Architectural Remnants™
Coastal Living™ Patina
Rustics™ Premium
 25 Year Residential
 10 Year Light Commercial

New England Long Plank
Forest Select XL
 25 Year Residential
 8 Year Light Commercial

Timberland Classics
 20 Year Residential
 3 Year Light Commercial

WHAT WILL WE DO IF ANY OF THE COVERED EVENTS OCCUR?

If there are visible defects before the product is installed, any uncut pieces that appear to have defects should be returned to the original place of purchase; those pieces that do not meet our specifications will be replaced. This pre-installation defects warranty expires upon installation.

If any of the covered events occur within the warranty periods specified for the respective flooring product, we will at our cost recoat, refinish, fill or furnish comparable flooring (of our manufacture and of similar colour, pattern and quality), for either the repair of the defective area or the

replacement of the floor, at our option, but not including installation costs.

In the unlikely event that we are unable to correct the problem after a reasonable number of attempts, we will refund the portion of the purchase price for the section of failed flooring.

If your floor was professionally installed, we will also pay reasonable labour-costs for the direct repairs or replacement as noted within the relevant warranty period. This does not include labour involved in removal or replacement of cabinets and other fixtures.

Years from Date of Original Purchase	What we will do
Prior to installation	Any uncut pieces that appear to have defects should be returned to the original place of purchase; those pieces that do not meet our specifications will be replaced.
One (1)	Armstrong Flooring will replace/repair at its discretion the defective product including reasonable labour charges for installation. If replaced, Armstrong will replace it with similar quality first grade material. This replaced material will be Warranted for a further Fifteen (15) years on the same terms as this Defects Warranty and subject to the same conditions (in each case, to the extent permissible by law at that time). If repaired, the material is Warranted for the time then remaining under this original Warranty.
Two (2)	Armstrong Flooring will replace/repair at its discretion the defective product and pay 50% of a reasonable labour charge for installation (including any GST payable to an installer who is registered for GST) on receipt of a tax invoice from the installer.
Residential Three (3) – Twenty Five (25)* ^{2,3}	Armstrong Flooring will replace/repair at its discretion defective material only (excluding cost of installation).
Residential Three (3) – Twenty (20)* ¹	Armstrong Flooring will replace/repair at its discretion defective material only (excluding cost of installation).
Light Commercial Three (3)* ¹ – Ten (10)* ³	Armstrong Flooring will replace/repair at its discretion defective material only (excluding cost of installation).
Light Commercial Three (3)* ¹ – Eight (8)* ²	Armstrong Flooring will replace/repair at its discretion defective material only (excluding cost of installation).



*¹Timberland Classics, *²Forest Select and New England, *³Architectural Remnants™, Coastal Living™ Patina, Rustics™ Premium

Where the purchaser is not a 'consumer' for the purposes of the Australian Consumer Law (which will depend upon a variety of factors including the price of the goods, the purchaser's purpose in acquiring the goods, and the categorisation of the goods), or where the products to which this Warranty applies are not goods 'of a kind ordinarily acquired for personal, domestic or household use or consumption', then to the extent permitted under the Australian Consumer Law, Armstrong Flooring will not be liable for any direct or indirect consequential loss in relation to any product defects. Nothing in this paragraph or the Warranty is intended to, or attempts to, exclude or limit the operation of the Australian Consumer Law in any respect.

USE AREA CLASSIFICATIONS

Use areas for Laminate products are defined by testing to DIN EN 13329 (2009-01) Laminate floor coverings – Elements with a surface layer based on aminoplastic thermosetting resins – Specifications, requirements and test methods (includes Amendment A1:2008).

For the purpose of this warranty the following are Armstrong recommended use areas for the listed products.

PRODUCT	USE AREA CLASSIFICATION	
	Residential Heavy 23	Commercial Commercial 31 Light/Moderate
		
*1Timberland Classics, *2Forest Select and New England	Heavy traffic; suitable for all areas. (not bathrooms, shower rooms or laundries).	Not applicable
*2Forest Select and New England, *3Architectural Remnants™, Coastal Living™ Patina, Rustics™ Premium	Heavy traffic; suitable for all areas. (not bathrooms, shower rooms or laundries).	Light/Moderate traffic; Boutique, hotel room, small office. (not bathrooms, shower rooms or laundries).

WHAT IS NOT COVERED BY THESE WARRANTIES?

- Without limited or restricting the other rights and remedies that may be available to you under the Australian Consumer Law or any other law in relation to the flowing product, these warranties do not cover:
- Any other person (the warranties are not transferable).
- Damage caused by fire, flooding and other natural disasters and Acts of Nature.
- Damage caused by negligence, accidents, misuse or abuse.
- Damage caused by lack of proper maintenance or failure to follow all of our written maintenance instructions. Use of floor care products other than those specially formulated for use on Armstrong flooring may damage your floor and may void the warranty.
- Damage caused by vacuum cleaner beater bar or hard heads (see Product Care and Maintenance Guidelines).
- Damage caused by appliances, furniture and castors (see Product Care and Maintenance Guidelines).
- Damage caused by cutting from sharp objects (see Product Care and Maintenance Guidelines).
- Reduction in gloss, scratches or indentation due to sand, pebbles or other abrasives, spiked heel shoes, pets, insects, construction traffic, water, moisture, or failure to maintain the floor as required (see Product Care and Maintenance Guidelines).
- Minor colour, shade or texture variations between samples, printed colour photography or replacement flooring and the actual material.
- Minor colour variations between flooring and or samples and other flooring or wood products, which you wish to, match (e.g. cabinets, stair railings, trim, etc.).
- Deficiencies related to subfloor/floor joist assemblies, subfloor preparation materials and fasteners including, but not limited to, uneven subfloor surfaces, floor deflection or voids in the subfloor.
- Noises (squeaks, etc.) associated with anything other than the incorrect manufacture of the flooring.
- Changes in colour due to exposure to sunlight and age.

- Use of the floor covering in an outside / external location.
- Floors that are installed in other than owner-occupied or tenant-occupied residences.
- Commercial installations of residential products unsuitable for commercial traffic.
- Delivery, construction or installation-related damage including installations made: (i) in breach of applicable local housing or building codes or standards, or (ii) contrary to written instructions furnished with the project.
- Floors damaged or adhesive breakdown caused by subfloor moisture of water damage, including without limitation, due to broken or leading water pipes or gutters, flooding, water spills or weather conditions or acts of Nature.

FALSE OR EXAGGERATED CLAIMS

We may refuse to action a claim in relation to these Warranties, or reduce the benefits available to you in respect of the claim, if, in our reasonable opinion, you make any misrepresentation or commit any fraudulent dishonest act or omission in connection with the claim. Nothing in this paragraph limits our consumer guarantee obligations to you.

THESE WARRANTIES CANNOT BE VARIED

None of our installers, retailers, distributors or employees has the authority to alter the obligations, limitations, disclaimers or exclusions under any of these warranties.

PRIVACY

We may use and disclose your contract and related warranty information to our insurers, claims managers, repairers and suppliers (including to any person situated outside Australia) for the purpose of:

- Processing claims in relation to your Warranty
- Repairing or replacing the flooring product under your Warranty.

You consent to these parties contacting you, including sending email, mail or making contact by telephone, for the purposes set out above. You confirm you have the necessary authority to provide the information and to give these consents.

INSTALLATION INSTRUCTIONS

Armstrong Flooring – Laminate

GENERAL INFORMATION

Installer Responsibility

- Armstrong Flooring – Laminate is a 'floating floor'. These Laminate Floors are intended for indoor use only and can be installed over most existing floor structures. Since these floors are composed of natural cellulose fibres, they will expand and contract with changes in relative humidity.
- Prior to installation, the installer has final inspection responsibility as to manufacture and factory finish. The installer must use reasonable selectivity and hold out or cut off pieces with deficiencies, whatever the cause. Should the individual piece be doubtful, the installer should not use the piece.
- This inspection of all flooring should be done before installation. Carefully examine flooring for colour, finish and quality before installing it. If material is not acceptable, do not install it and contact the seller immediately.
- Prior to installation, the installer must determine that the job-site environment and the subfloors involved meet or exceed all applicable standards.
- Recommendations of the construction and materials industries as well as local codes must be followed. These instructions recommend that the construction and subfloor be dry, stiff, structurally sound and flat.
- The manufacturer declines any responsibility for job failure resulting from or associated with subfloor and substrates or job-site environmental deficiencies.
- Use of stain, filler or putty stick for touch-up and appropriate products for correcting subfloor voids is accepted as part of normal installation procedures.

Floating Laminate Floor Structure

- Do not attach to the subfloor at any point.
- The installation of cabinets or island benches over the top of the flooring and fixed to the floor and subfloor void manufacturer's warranty. This can lead to the floor failing to contract and expand when environmental changes occur. Do not fit flush against any fixed vertical surfaces like walls, permanent fixtures, door frames, pipes, staircases and where the floor meets other floor coverings.
- For most installations, where the relative humidity is between 50 and 65%, a minimum 10mm expansion gap is required around the perimeter of the room as well as against any fixed objects. This gap accounts for the normal movement of the floor system.
- Where the room is longer than 8m in length or wider than 6m across the width of the room, expansion joints must be provided to allow contraction and expansion with environmental changes. When installing the floor into several adjoining rooms, expansion joints must be provided at every doorway.
- Any expansion joint in the subfloor must be provided with a matching expansion joint directly above in the Armstrong Flooring Laminate products
- Do not install Armstrong Flooring Laminate products in areas such as bathrooms, showers and wash rooms, steam rooms, saunas or where the floor is normally/frequently wet.
- The room temperature should be at a minimum of 18°C for 48 hours prior to, during and 48 hours after installation.

INSTALLATION TOOLS REQUIRED

- Armstrong Flooring - Laminate
- Polyethylene plastic sheeting for moisture barrier
- Foam underlay with attached moisture barrier(2mm)
- 50mm wide water resistant tape
- Tapping block
- Pull bar
- Spacers/wedges
- Tape measure
- Carpenter's square
- Hammer
- Pencil
- Saw (such as Jig, Circular, Table, Undercut, Drop, Hand)
- Dividers
- Mouldings/finishing trims

SUBFLOOR REQUIREMENTS

Armstrong Flooring Laminate products can be installed over most subfloors and existing floors on all grade levels.

E.G. Over smooth, well bonded vinyl floors; over concrete, ceramic tile, terrazzo, and marble; and over firmly secured strip timber flooring and board type underlayment's.

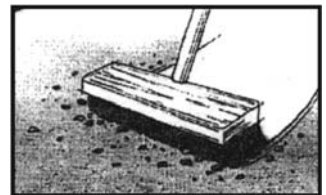

All sub-floors must;

- meet applicable building codes
- be structurally sound
- be dry, clean and flat.

The subfloor must not deviate by more than 2mm in 1.5m. All depressions greater than 2mm must be filled with a suitable levelling compound or the hump removed by grinding (Diamond grinding is preferable).

The slope should not exceed 30mm in 2 metres.

NEW AND EXISTING CONCRETE SUB-FLOORS

Concrete sub-floors must be dry. Concrete sub-floors, regardless of their age, MUST always be tested prior to the installation of laminate flooring. Follow the ASTM 2170 as a guide for testing. If the concrete sub floor is showing high moisture vapour readings, floating laminate wood floors should not be installed until the problem has been rectified. Armstrong Flooring recommend to install 200 micron Polyethylene plastic sheeting overlapping joints by 200mm and securing with a 50mm water resistant tape and lapped up the wall 10 to 15mm as a moisture barrier.

NEW AND EXISTING TIMBER SUB-FLOORS

New and Existing Timber sub-floors must be inspected prior to installation. The timber floor should be suspended and have a minimum of 450mm well ventilated crawl space as shown in diagram on right.

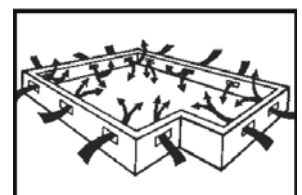

The acceptable moisture content range of a timber floor is 10 to 14%, this can be checked following the ATFA moisture test guide lines for timber flooring.

- If the timber sub floor is showing high moisture vapour readings, floating laminate wood floors should not be installed until the problem has been rectified.
 - it is recommended to install Polyethylene plastic sheeting overlapping joints by 200mm and securing with a water resistant tape and lapped up the wall 10 to 15mm as a moisture barrier.

All boards must be properly fixed to the substrate. Loose or creaking boards will result in a squeaking floor after installation and must be securely fixed. All protruding nail heads are to be punched below the surface.

EXISTING FLOOR COVERINGS

All existing floor coverings MUST be securely bonded to the acceptable condition sub-floor.

Any loose sections MUST be re-fixed, replaced or the floorcovering removed.

All sub-floors MUST be tested for moisture content.

1. CONDITIONING/ACCLIMATISATION

Store Armstrong Flooring Laminate products flat in unopened package in the centre (protected dry place) of the room in which it will be installed for a period of 24 hours prior to installation.

The room temperature should be at a minimum of 18°C for 48 hours prior to, during with an ideal relative humidity of 55% and 48 hours after installation.

During installation, the room temperature should not exceed 38°C.

Can be installed over under-floor heating systems. The surface of the sub-floor must not exceed 28°C.

The packages should only be opened just before the start of installation. Each board should be carefully inspected prior to installation, never install any damaged board.

The floorboards are supplied pre-finished. Open the packages as work progresses to minimise their exposure to humidity.

If any obvious defects or damage are found when opening a package, call your flooring retailer or place of purchase.

2. INSTALLATION

2.1 PREPARATION

Ensure sub-floor is to acceptable standard (see sub-floor requirements).

Remove any existing wall base or trim.

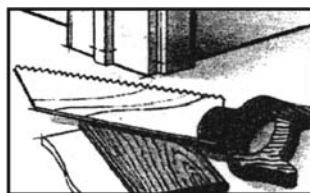

Door trims and architraves must be undercut to allow the floor to move freely. Use a piece of floor and foam underlay to support the saw blade at the correct height for undercutting. It may be necessary to plane or cut the bottom of the door to accommodate the change in floor height.

Use a Vacuum to remove all the dust and debris from under the architraves walls and off the sub floor.

2.3 LAYOUT

The boards should preferably be installed in the direction of incoming light. Avoid narrow pieces at the finish wall. Measure the distance between the starting wall and

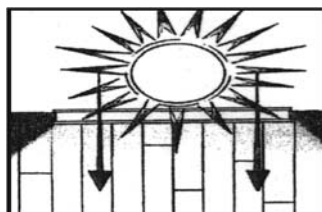

finish wall. Divide this measurement by the width of the board. If the remainder is less than 60mm, allow to cut off 60mm from the width of the first row.

2.4 INSTALL FOAM UNDERLAYMENT

Use a 2mm foam underlay with attached moisture barrier, following manufacturer's instructions. The excess should be cut to the height of the installed flooring after the floor has been installed. Tape joints with 50mm water resistant tape.

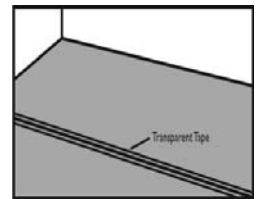

2.5 INSTALL THE FIRST ROW

Inspect each piece prior to installation for damaged boards or coking systems.

Always pull from at least 3 cartons while installing to minimize pattern repeats.

Lay first row with the small tongue side facing the wall.

If the starting wall is crooked, make sure the first row is square to the rest of the installation and trace the contour of the wall on the first row of planks allowing for any adjustments needed for the last row, trim as needed.

- Put spacers around the entire perimeter of the room to maintain minimum 10mm expansion zone (as per diagram), remove when installation is complete.

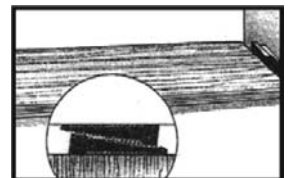

- Lay pieces from left to right. Lock the end joints by overlapping the ends and align corners creating a continuous board.
- When measuring the last piece in the row, subtract minimum 10mm from end of board to maintain expansion zone.
- Cut decorative side up if using hand saw or decorative side down if using power saw to minimize chipping.
- If the cut-off piece from the first row is 200mm or longer, use it to start the second row. If it is shorter than 200mm, cut a full board in half and use that to start the next row.

2.6 INSTALL ALL SUBSEQUENT ROWS

- Continue laying boards, one row at a time, staggering the end joints.

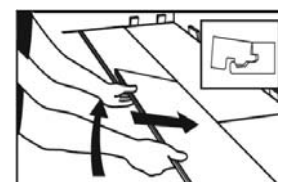
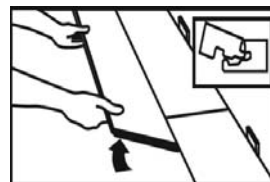

- Be attentive to staggering the ends of boards in adjacent rows at a minimum of 150mm (Figure#2). This will help ensure a more favourable overall appearance of the floor.

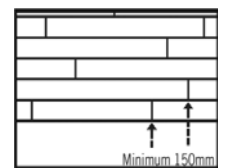
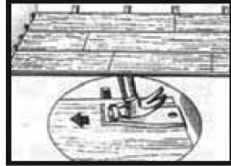

Figure #2 Preferred Alignment

- Install the long end of the first board in the second row at an angle to the board in the first row. Press flat to subfloor to lock into place.
- Angle the long end of the next board in the second row to lock into the first row.

- Follow the order described to continue laying the boards in the second and additional rows.
- If necessary use a pull bar to tighten joints.



2.7 INSTALLING THE LAST ROW

- The last row may need to be cut lengthwise to fit.
- Place the row of boards to be installed on top of the last row of installed boards.
- Use a divider or piece of the board as a scribe to trace the contour of the wall.
- Use a spacer between the marker and the piece of board.
 - This adds the expansion gap required.
- Install the last row.
- Insert spacers to hold the row in place.

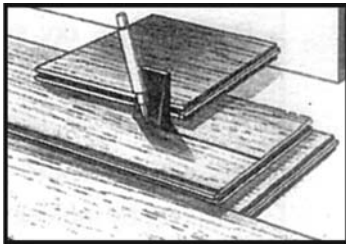

2.8 INSTALL MOULDINGS & TRANSITION STRIPS

- Remove spacers and install finish mouldings and transition strips.
- Attach mouldings and transition strips with nails, screws or construction adhesive (follow manufacturer's instructions)
- Pre-drill mouldings and transition strips prior to nailing or screwing.
- Never fasten the mouldings or transition strips to the laminate flooring and always maintain 10mm expansion zone.
- T-mouldings (to allow expansion/contraction) must be used where the room is larger than 24.38m in board length or wider than 15.85m in board width.
- T-mouldings (to allow expansion/contraction) must be used where the flooring continues through a doorway or passageway into another room (install beneath door).

MAINTENANCE INSTRUCTIONS

Armstrong Flooring – Laminate

DAILY/REGULAR MAINTENANCE

Residential/Light Commercial Foot Traffic:

- Vacuum, dust/micro fibre mop or sweep to remove debris on a frequent basis.
- Regularly spray clean your floor with Peerless JAL Hardwood and Laminate (or similar) floor cleaner, process as follows.
 1. Spray light film of Hardwood and Laminate floor cleaner over small area approx. 2 metre square.
 2. Immediately wipe flooring with micro fibre mop to remove residue.
 3. Do not allow excess cleaner to remain on the floor surface as excess will damage the flooring.
 4. Spot clean stubborn soils by spraying Peerless JAL Hardwood and Laminate floor cleaner and wiping with micro fibre cloth. Repeat if necessary.

FOR BEST RESULTS

- Clean up liquid spills immediately.
 - DO NOT
 - Wet Mop laminate floor.
 - Use steam mops on laminate floor.
 - Use mops with oil treated covers.
 - Place black rubber blocked mats, wheels or tyres on laminate floors. These will stain your floor.
- Surface dirt, grit, grease or high heel marks should be addressed immediately.
- Remove tough spots like shoe polish, tar and asphalt driveway seal with adhesive cleaner, low-odour mineral spirits or nail polish remover containing acetone (follow instructions on label).

- Soap-based detergents or “mop and shine” products are not recommended for use on laminate floors as these may leave a dull film on your floor.
- Do not apply wax or polish your floor.
- For added protection, use floor protectors (such as felt) on chairs and other furniture. The heavier the item, the wider the floor protector should be.
- When using a vacuum cleaner, disengage the beater bar and use the bare floor setting.
- Place a natural or colourfast mat at outside entrances to collect tracked-in dirt and absorb excess moisture. Also place wipe off mats at the inside of every entrance.
- Metal caster wheels can damage the floor. Instead, we recommend using soft white or grey wheels wide enough to support the load.
- For minor abrasions or scratches, use a touch-up kit or acrylic filler to repair.
- Major damage can be repaired with a plank replacement.

CAUTION: WOOD DUST

Sawing, sanding and machining wood products can produce wood dust. Airborne wood dust can cause respiratory, eye and skin irritation. The International Agency for Research on Cancer (IARC) has classified wood dust as a nasal carcinogen in humans.

Precautionary Measures: If power tools are used, they should be equipped with a dust collector. If high dust levels are encountered, use an appropriate designated dust mask. Avoid dust contact with eyes and skin.

First Aid Measures in case of Irritation: flush eyes or skin with water for at least 15 minutes.

ARMSTRONG FLOORING PTY LTD

FLOORCOVERINGS, ADHESIVES & ACCESSORIES MANUFACTURED IN AUSTRALIA AFTER 1st JANUARY, 1984 DO NOT CONTAIN ASBESTOS



WARNING

Vinyl flooring and adhesives manufactured in Australia prior to 1st January, 1984 may contain asbestos.

Do not sand, dry sweep, dry scrape, drill, saw, beadblast, or mechanically chip or pulverise existing resilient flooring, backing, lining felt or asphaltic 'cut-back' adhesives.

These products may contain either **asbestos fibres** or **crystalline silica**.

Avoid creating dust. Inhalation of such dust is a cancer and respiratory tract hazard.

Unless positively certain that the product to be removed is a non-asbestos containing material, you must presume it contains asbestos. Regulations may require that the material be tested to determine asbestos content.

Where do I go to find out more about asbestos?

Asbestos Awareness www.asbestosawareness.com.au – provides information

on a state by state basis about the dangers of asbestos, asbestos removal, who to contact and other important information.

NOTE: Vinyl flooring manufactured in Australia after January 1, 1984, **DOES NOT** contain asbestos. However, regulations, codes and directives as to the best method of handling asbestos do exist and it is the obligation of the installer to ensure that practices used are safe, without risk to health, and meet all legal requirements.

Disclaimer—Asbestos issues

The warnings and guidance contained in these instructions in relation to the potential for asbestos in floorcovering materials are given in good faith. However, regulations, codes and directives as to the best method of handling asbestos are under continual revision. It is the obligation of the installer to ensure that practices used are safe, without risk to health, and meet all legal requirements.

Armstrong Flooring Pty Ltd accepts no liability for any loss, costs, expense or injury, however incurred, arising from the presence of any asbestos in any floorcovering materials or asphaltic 'cut-back' adhesives and/or any reliance placed upon the procedures and recommended practices contained in these instructions.

Inspiring Great Spaces™



RESIDENTIAL FLOORING

Armstrong Flooring Pty Ltd
29 – 39 Mills Road, Braeside, 3195 Victoria Australia

For further information and samples:
Australia Freecall 1800 800 518
Email customer_services@armstrongflooring.com or contact us on the web

www.armstrongresidentialfloors.com.au

January 2016